



The School District *of* Haverford Township

Haverford HS Program/Capacity Study & Lynnewood ES Update

August 23rd 2018



HAVERFORD HIGH SCHOOL



HIGH SCHOOL PROGRAM/CAPACITY

HAVERFORD HIGH SCHOOL

	High School		
Year	Projected Enrollment	Annual Delta	Cumulative from 2017
2012	1707		
2013	1737	30	
2014	1728	-9	
2015	1712	-16	
2016	1724	12	
2017	1772	48	
2018	1795	23	23
2019	1855	60	83
2020	1922	67	150
2021	1951	29	179
2022	2033	82	261
2023	2063	30	291
2024	2109	46	337
2025	2181	72	409
2026	2210	29	438
2027	2187	-23	415

District directive to design for 400 additional students

HAVERFORD HIGH SCHOOL

Task

- Conduct a comprehensive capacity study of Haverford High School to determine the appropriate number of classrooms to accommodate long-term enrollment projections.
- Determine the current number and type of classrooms, daily usage patterns, and any planned modifications to educational programming or scheduling
- Apply this data to the district's long-term enrollment projections to calculate the number of classrooms required

HAVERFORD HIGH SCHOOL

ADDITIONAL CLASSROOMS

Process

- Held meetings with district & high school administration
- High school administration provided detailed spreadsheet on classroom utilization, average class size, desired class capacity, etc.
- KCBA reviewed current utilization + average class size and analyzed available space within current class capacity
- KCBA determined a number of additional classrooms needed based on amount of capacity not met within the current high school structure

HAVERFORD HIGH SCHOOL

DISTRICT INFORMATION

	A	B	C	D	E	F	G	H	
1	Room	Department	Description	Te	# Blocks Used/Quar	% Utilizat	Max Class S	Ave. Class S	NOTES
307	253	SCIENCE	SCIENCE LAB (BIO)	Q1	4	100%	30	27	
308	253	SCIENCE	SCIENCE LAB (BIO)	Q2	4	100%	30	27	
309	253	SCIENCE	SCIENCE LAB (BIO)	Q3	4	100%	30	27	
310	253	SCIENCE	SCIENCE LAB (BIO)	Q4	4	100%	30	27	
311	253 Average					100%		27	
312	255	SCIENCE	SCIENCE LAB (PHYSICS)	Q1	4	100%	30	23	
313	255	SCIENCE	SCIENCE LAB (PHYSICS)	Q2	4	100%	30	23	
314	255	SCIENCE	SCIENCE LAB (PHYSICS)	Q3	4	100%	30	20	
315	255	SCIENCE	SCIENCE LAB (PHYSICS)	Q4	4	100%	30	20	
316	255 Average					100%		21.5	
317	256	BUSINESS		Q1	4	100%	30	19	
318	256	BUSINESS		Q2	4	100%	30	18	
319	256	BUSINESS		Q3	4	100%	30	20	
320	256	BUSINESS		Q4	4	100%	30	22	
321	256 Average					100%		19.75	
322	257	SCIENCE	SCIENCE LAB (PHYSICS)	Q1	4	100%	30	22	
323	257	SCIENCE	SCIENCE LAB (PHYSICS)	Q2	4	100%	30	22	
324	257	SCIENCE	SCIENCE LAB (PHYSICS)	Q3	4	100%	30	20	
325	257	SCIENCE	SCIENCE LAB (PHYSICS)	Q4	4	100%	30	20	
326	257 Average					100%		21	
327	258	BUSINESS		Q1	4	100%	30	17	
328	258	BUSINESS		Q2	4	100%	30	15	
329	258	BUSINESS		Q3	4	100%	30	15	
330	258	BUSINESS		Q4	4	100%	30	16	
331	258 Average					100%		15.75	
332	259	SCIENCE	SCIENCE LAB (BIO)	Q1	3	75%	30	28	
333	259	SCIENCE	SCIENCE LAB (BIO)	Q2	3	75%	30	28	
334	259	SCIENCE	SCIENCE LAB (BIO)	Q3	3	75%	30	25	
335	259	SCIENCE	SCIENCE LAB (BIO)	Q4	3	75%	30	25	
336	259 Average					75%		26.5	
337	260	ENGLISH		Q1	4	100%	30	28	
338	260	ENGLISH		Q2	4	100%	30	28	

HAVERFORD HIGH SCHOOL

KCBA ANALYSIS

	A	B	C	D	E	F	G	H
			No.	Area	Desired Room Capacity	Max Room Capacity	Current Enrollment	Remarks
3								
4								
5	CORE ACADEMIC PROGRAMS							
6	English							
7	Classroom 129		1	704	25	30	27	homeroom: 2021S
8	Classroom 224		1	685	25	30	23	homeroom: 2021P
9	Classroom 226		1	683	25	30	23	homeroom: 2020P
10	Classroom 227		1	683	25	30	26	homeroom: 2021F
11	Classroom 228		1	688	25	30	22	homeroom: 2022M
12	Classroom 229		1	682	25	30	20	homeroom: 2020M
13	Classroom 230		1	688	25	30	25	homeroom: 2019E
14	Classroom 231		1	685	25	30	22	homeroom: 2020F
15	Classroom 232		1	982	25	30	19	homeroom: 2019F
16	Classroom 233		1	680	25	30	23	homeroom: 2022A
17	Classroom 234		1	755	25	30	15	homeroom: 2022T
18	Classroom 235		1	969	25	30	15	homeroom: 2021M
19	Classroom 237		1	941	25	30	17	homeroom: 2020G
20	Classroom 260		1	1,374	25	30	24	homeroom: 2021D, 2021
25	Existing Subtotal		14	11,199	350	420	297	
26							53	Available Capacity
27							84.8%	Desired Capacity Percen
29	Social Studies							
30	Classroom 201		1	632	25	30	23	homeroom: 2021L
31	Classroom 202		1	681	25	30	21	homeroom: 2021B
32	Classroom 203		1	687	25	30	23	homeroom: 2019O
33	Classroom 205		1	745	25	30	26	homeroom: 2019N
34	Classroom 207		1	1,052	25	30	24	homeroom: 2022P
35	Classroom 208		1	847	25	30	25	homeroom: 2021K
36	Classroom 210		1	684	25	30	23	
37	Classroom 212		1	687	25	30	25	homeroom: 2020Q

HAVERFORD HIGH SCHOOL

CORE ACADEMICS PROGRAM

	No.	Area	Desired Room Capacity	Max Room Capacity	Current Enrollment	Remarks
CORE ACADEMIC PROGRAMS						
English						
Existing Classrooms	14	800	25	30	21	
Existing Subtotal	14	11,199	350	420	297	
						53 Available Capacity
Social Studies						
Existing Classrooms	14	763	25	30	24	
Existing Subtotal	14	10,679	350	420	333	
						17 Available Capacity
Math						
Existing Classrooms	16	770	25	30	25	
Existing Subtotal	16	12,316	400	480	400	
						0 Available Capacity
World Language						
Existing Classrooms	9	752	25	30	22	
Existing Subtotal	9	6769	225	270	195	
						30 Available Capacity
Science Classrooms						
Existing Classrooms	14	1,259	25	30	25	
Existing Subtotal	14	17,628	350	420	348	
						3 Available Capacity
Business						
Existing Classrooms	3	950	25	30	18	
Existing Subtotal	3	2,851	75	90	54	
						21 Available Capacity

$53 + 17 + 0 + 30 + 3 + 21 =$
 124 Seats Available
- 400 Seats Planned
 = 276 Seats Still Needed
**11 Classrooms at 25 Seats
 per Classroom**

HAVERFORD HIGH SCHOOL

CORE ACADEMICS PROGRAM

Assignment of 11 Core Academic Rooms

- 2 English
- 2 Social Studies
- 2 Math
- 1 World Language
- 2 Science Labs
- 1 Business Lab
- 1 Special Education

HAVERFORD HIGH SCHOOL EDUCATIONAL SUPPORT PROGRAM

Chorus

55 Current Enrollment in 1,400 sf

72 Future Enrollment

72 capacity x 22.5 sf per student = 1620 sf Chorus Room

Orchestra

56 Current Enrollment in 1,200 sf

72 Future Enrollment

72 capacity x 30 sf per student = 2160 sf Orchestra Room

Band

74 Current Enrollment in 1,900 sf

95 Future Enrollment

95 capacity x 30 sf per student = 2850 sf Band Room

HAVERFORD HIGH SCHOOL EDUCATIONAL SUPPORT PROGRAM

Physical Education

Existing large 2 station gymnasium currently utilized to full capacity. The gymnasium is an above average size (13,000 sf) for a 2,000 student High School.

Lifetime Fitness classes are limited in availability due to spatial limitations. The fitness room will be expanded to allow for growing Lifetime Fitness capacity without the need for additional full size gymnasiums

HAVERFORD HIGH SCHOOL EDUCATIONAL SUPPORT PROGRAM

Family Consumer Sciences

50 Desired Capacity – 33 Current Capacity = **18 Available Seats**

Art

100 Desired Capacity – 69 Current Capacity = **32 Available Seats**

Note: 1 Art classroom currently not used for 2 quarters

Technology

100 Desired Capacity – 79 Current Capacity = **21 Available Seats**

HAVERFORD HIGH SCHOOL EDUCATIONAL SUPPORT PROGRAM

Educational Support Capacity

Enlarge chorus, orchestra, and band rooms to adequate size

Enlarge existing fitness room to adequate size

An aerial photograph of a suburban area featuring Haverford Middle School, a large green football field with a red running track, and a baseball field. The school building is a large, multi-winged structure with a red roof. Surrounding the school are residential streets with houses and trees. The text "BUILDING ADDITION OPTIONS" is overlaid in large, bold, grey letters with a slight shadow effect.

BUILDING ADDITION OPTIONS



Expanded
Parking

3-Floor
Classroom
Addition

1-Floor Addition



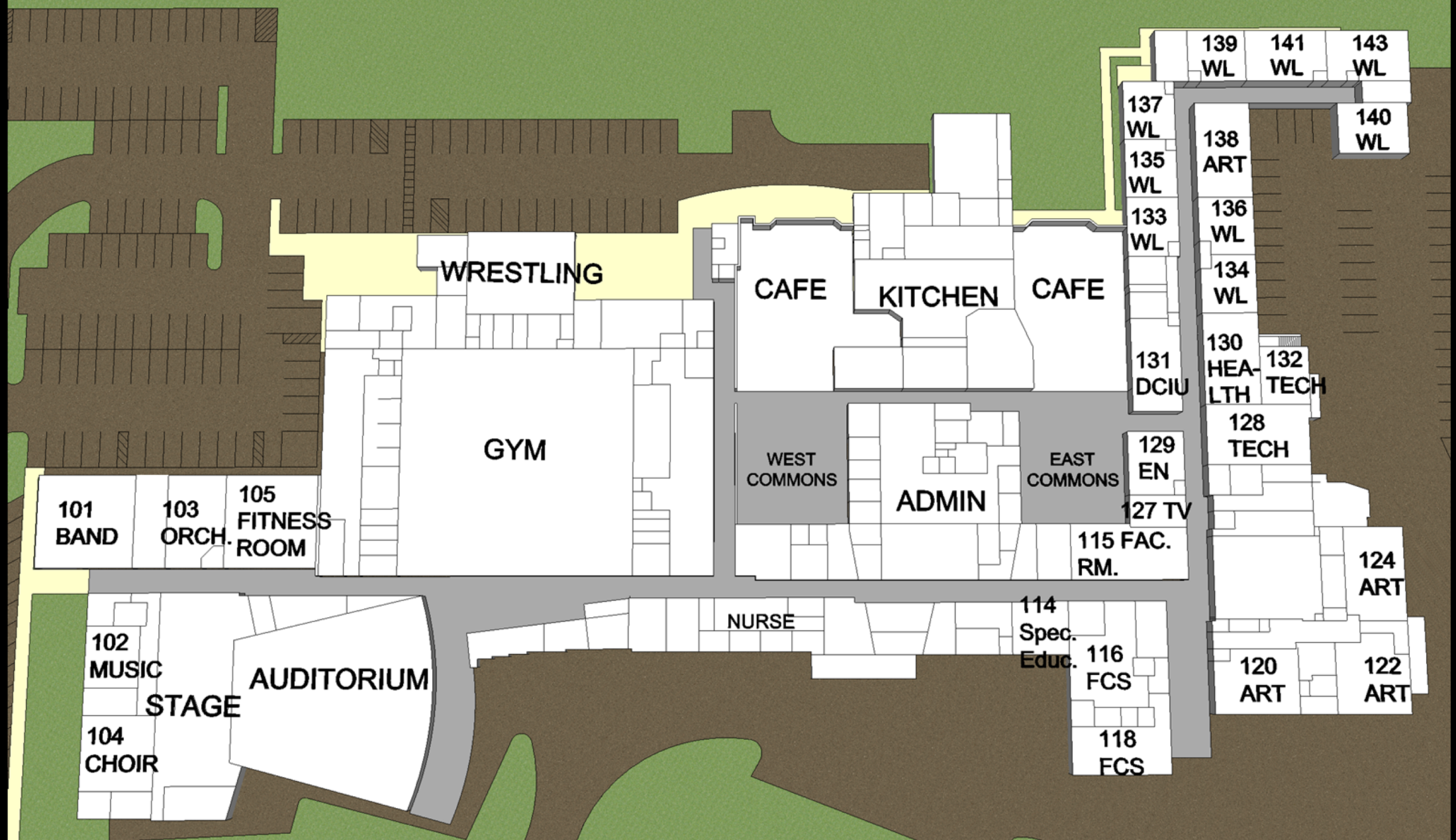

Haverford Senior High School
First Floor - Existing Floor Plan
School District of Haverford Township

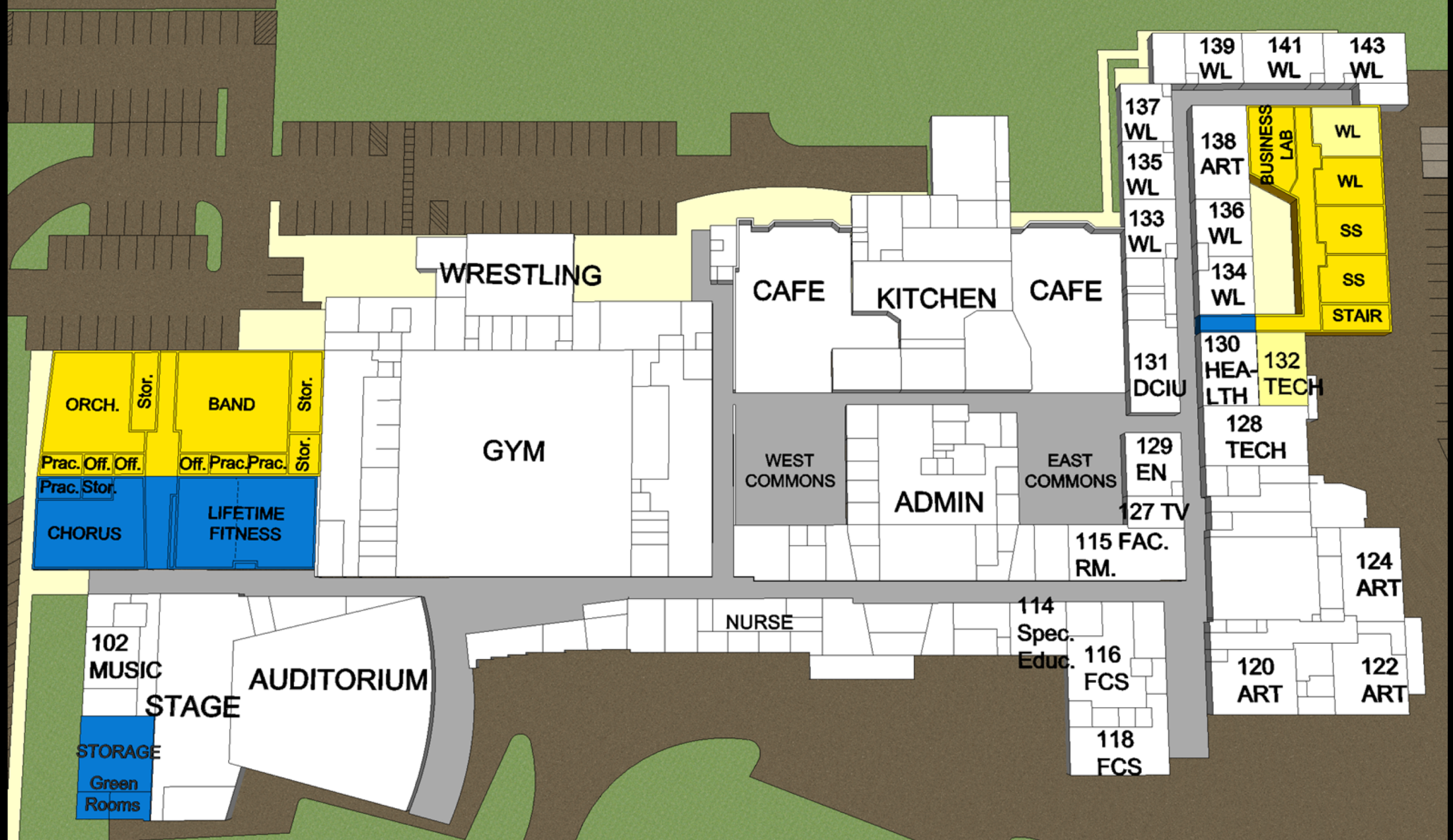

Haverford Senior High School
First Floor - Renovation & Additions
School District of Haverford Township

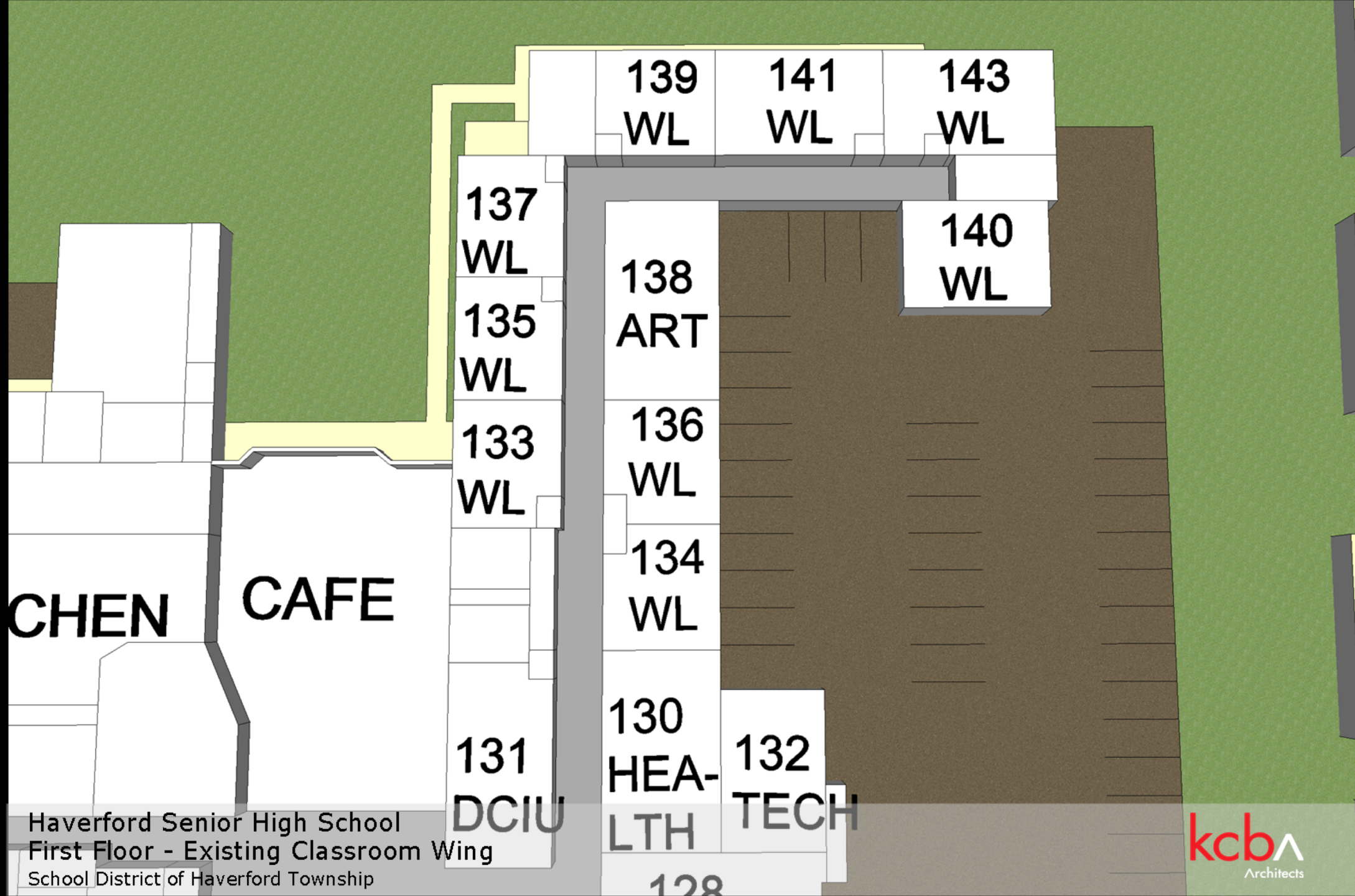

Haverford Senior High School
First Floor - Existing Classroom Wing
School District of Haverford Township

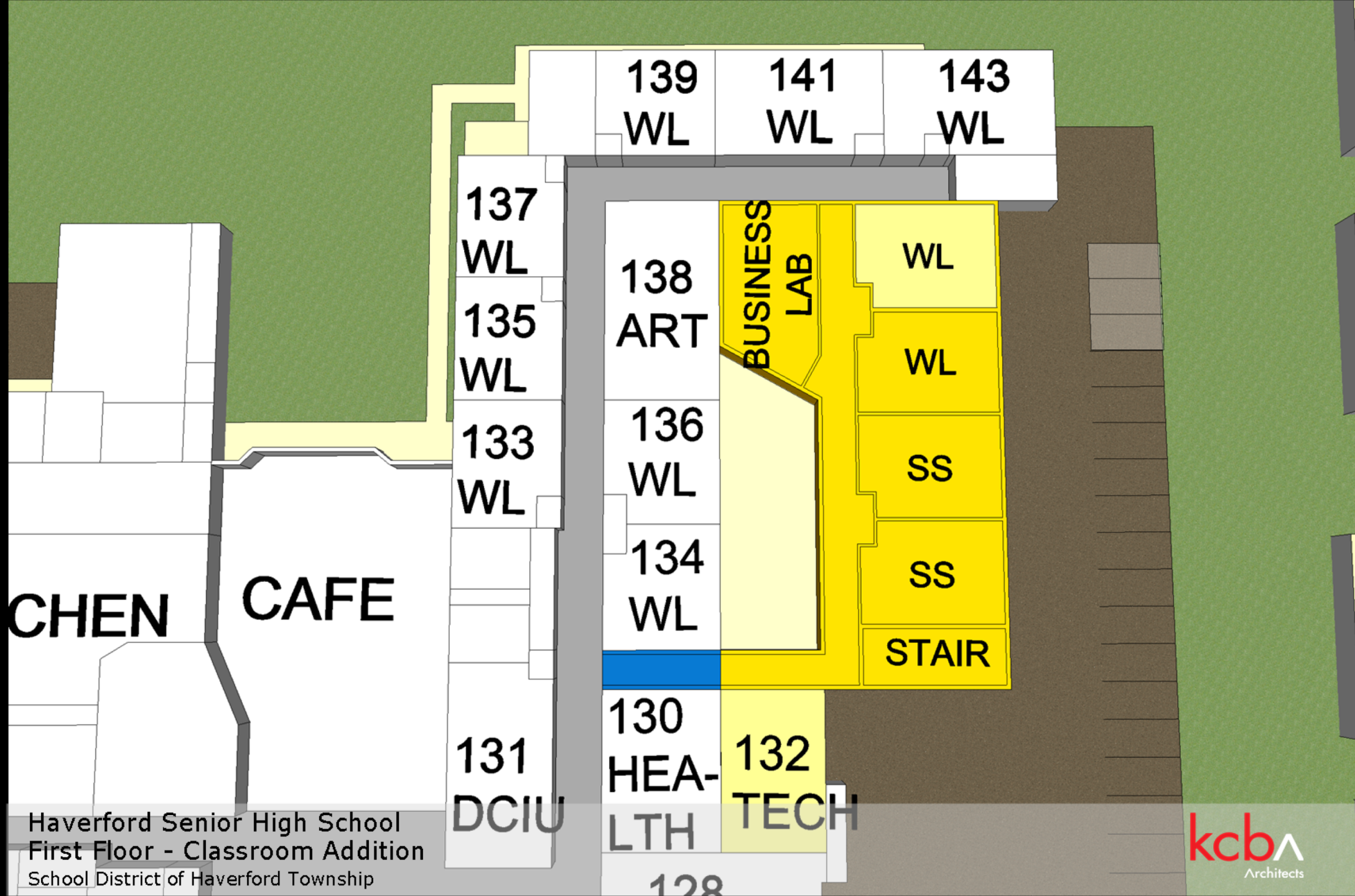

Haverford Senior High School
First Floor - Classroom Addition
School District of Haverford Township

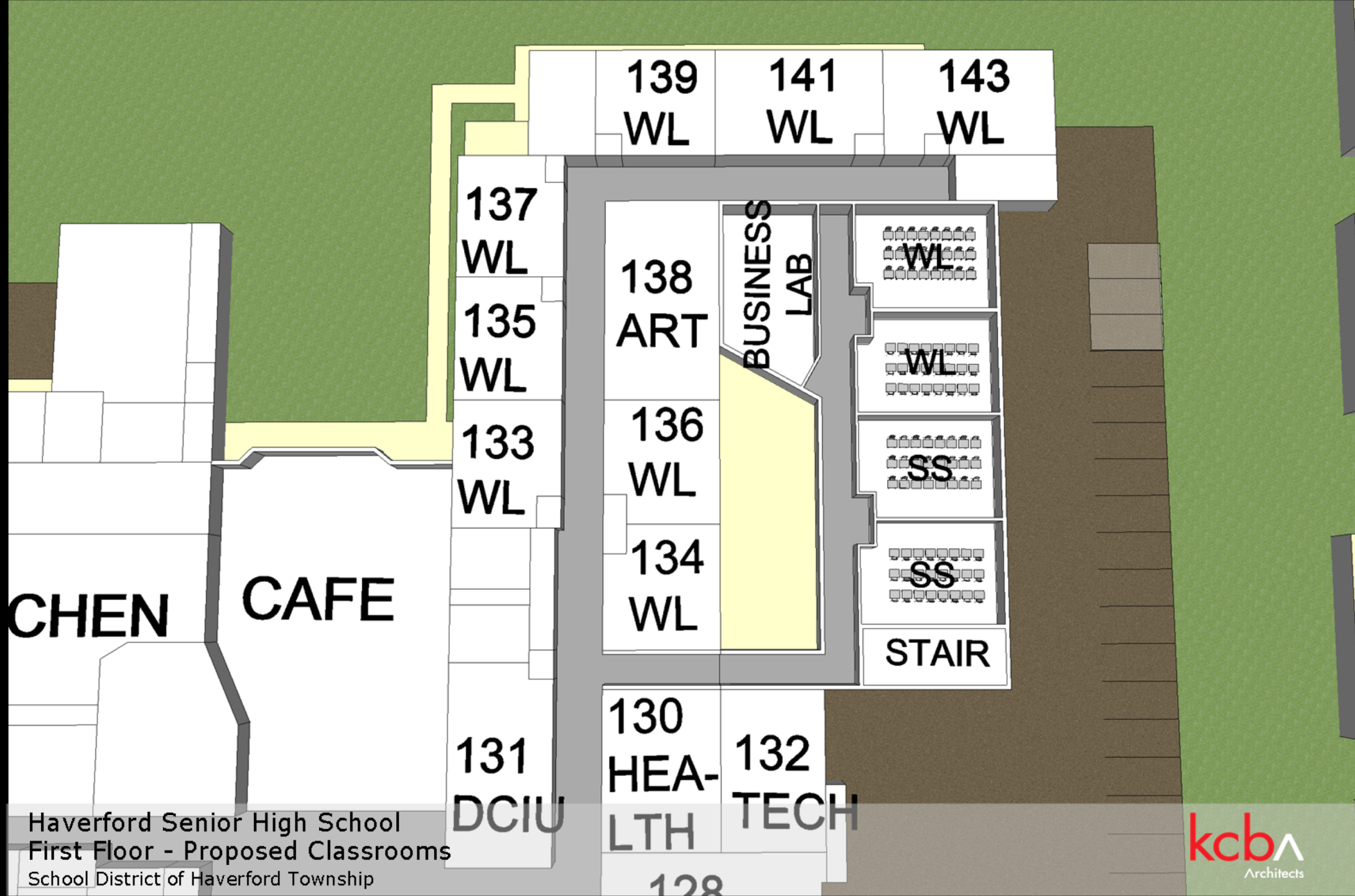

Haverford Senior High School
First Floor - Proposed Classrooms
School District of Haverford Township

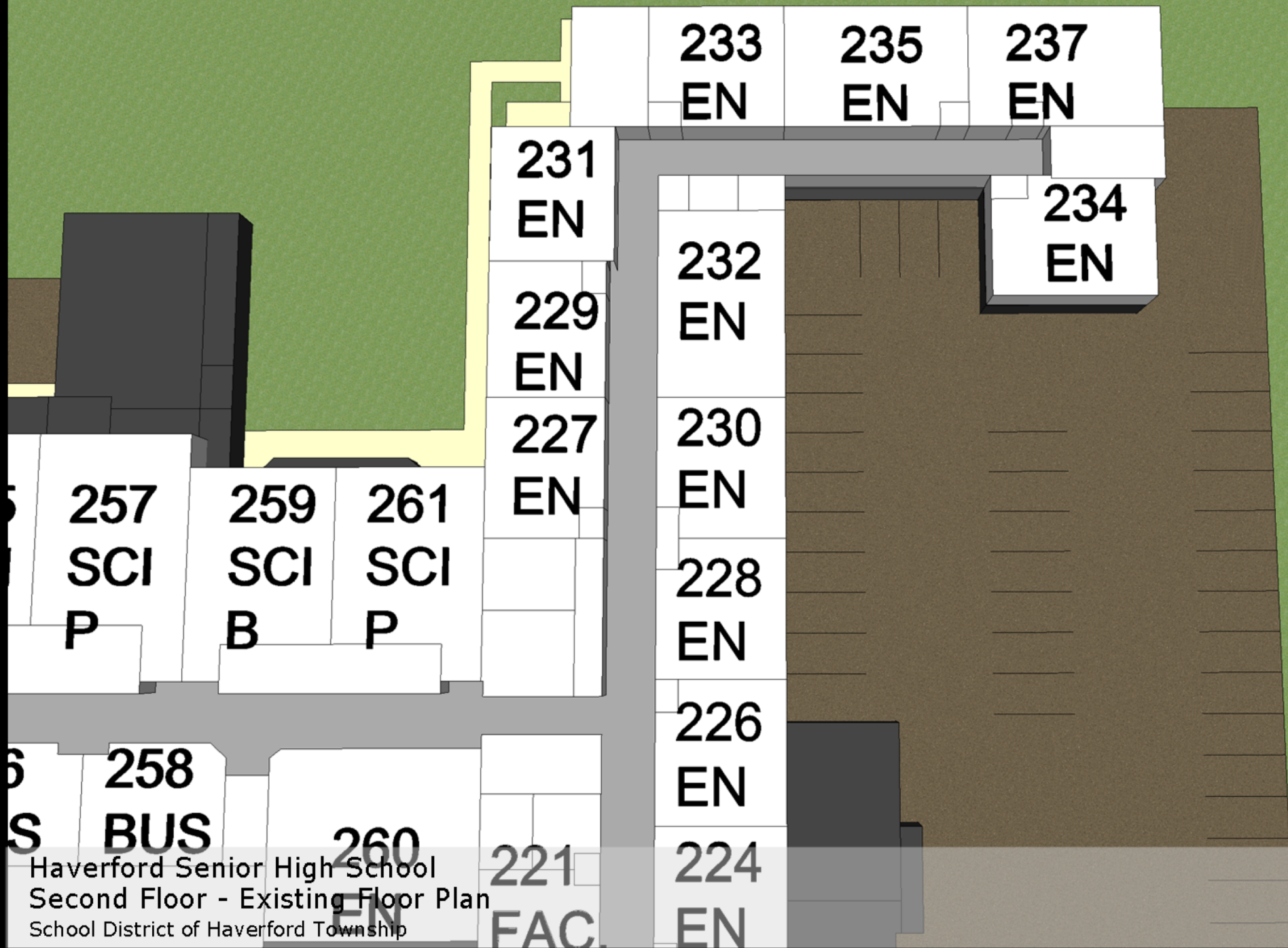

Haverford Senior High School
Second Floor - Existing Floor Plan
School District of Haverford Township

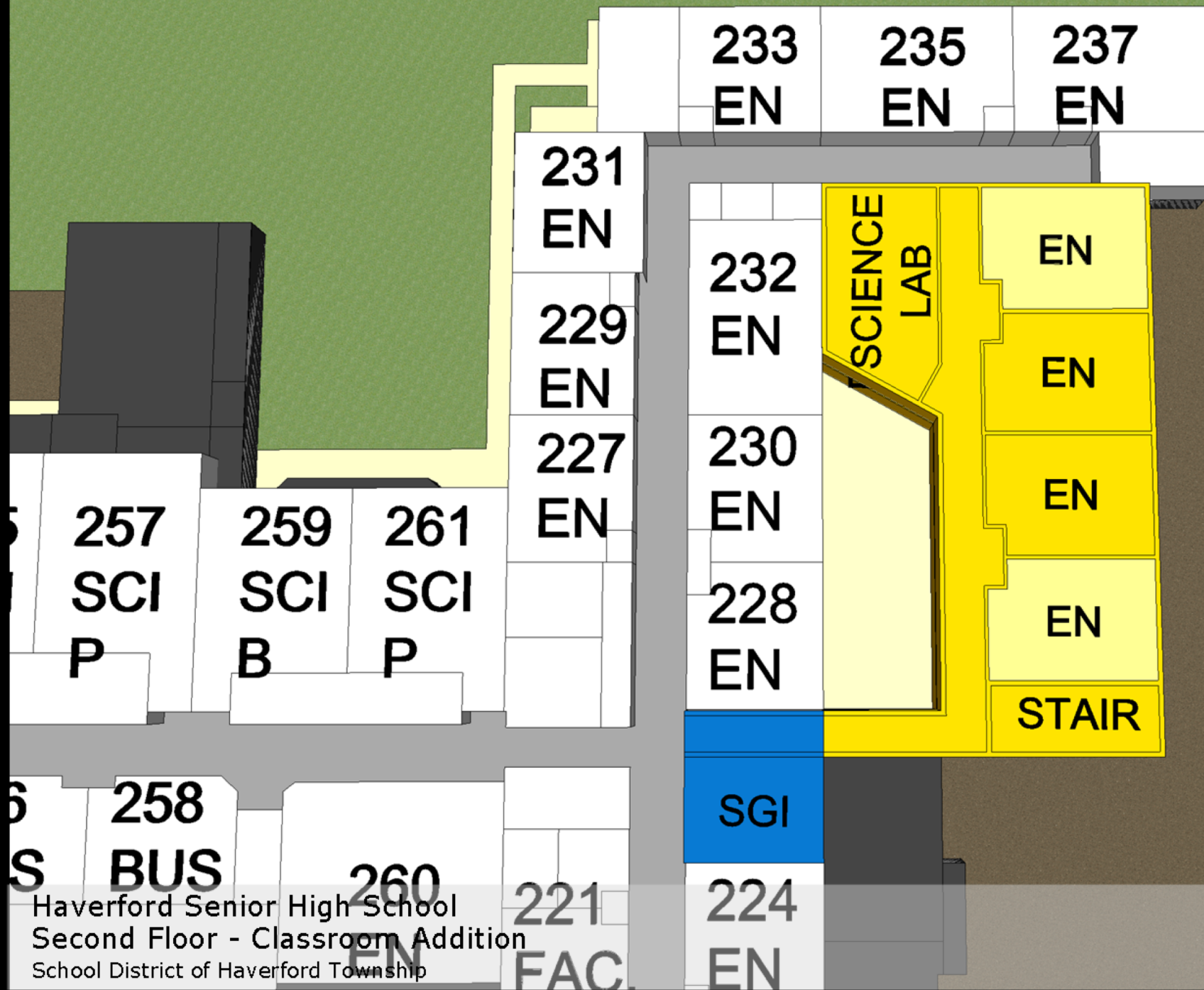

Haverford Senior High School
Second Floor - Classroom Addition
School District of Haverford Township

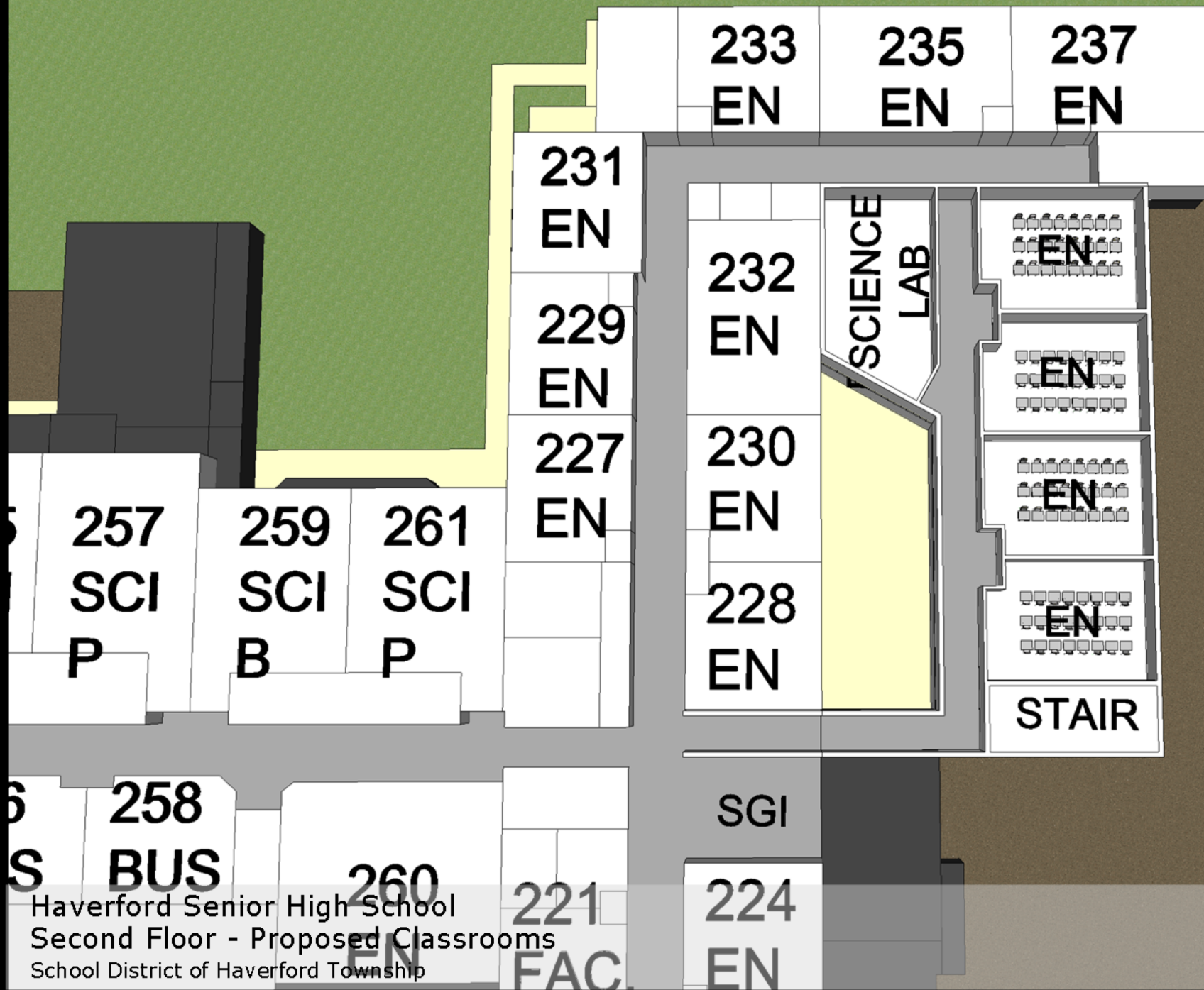

Haverford Senior High School
Second Floor - Proposed Classrooms
School District of Haverford Township