



The School District *of* Haverford Township

LYNNEWOOD ELEMENTARY SCHOOL

BIDDING UPDATE

APRIL 25, 2019



Lynnewood Elementary School
Site Analysis - Property Line & Set-Back
School District of Haverford Township



Lynnewood Elementary School
Site Analysis - Safety Zone & Buildable Area
School District of Haverford Township



Lynnewood Elementary School
Ghosted Existing Construction
School District of Haverford Township



Lynnewood Elementary School
Proposed Site Plan
School District of Haverford Township



FRONT ENTRANCE EXTERIOR



APPROACH ON LAWRENCE ROAD



CLASSROOM WING, PLAYGROUND, & CAFETERIA



RECEPTION & MAIN OFFICE



MAIN LOBBY



MAIN LOBBY



THE LEARNING CIRCLE

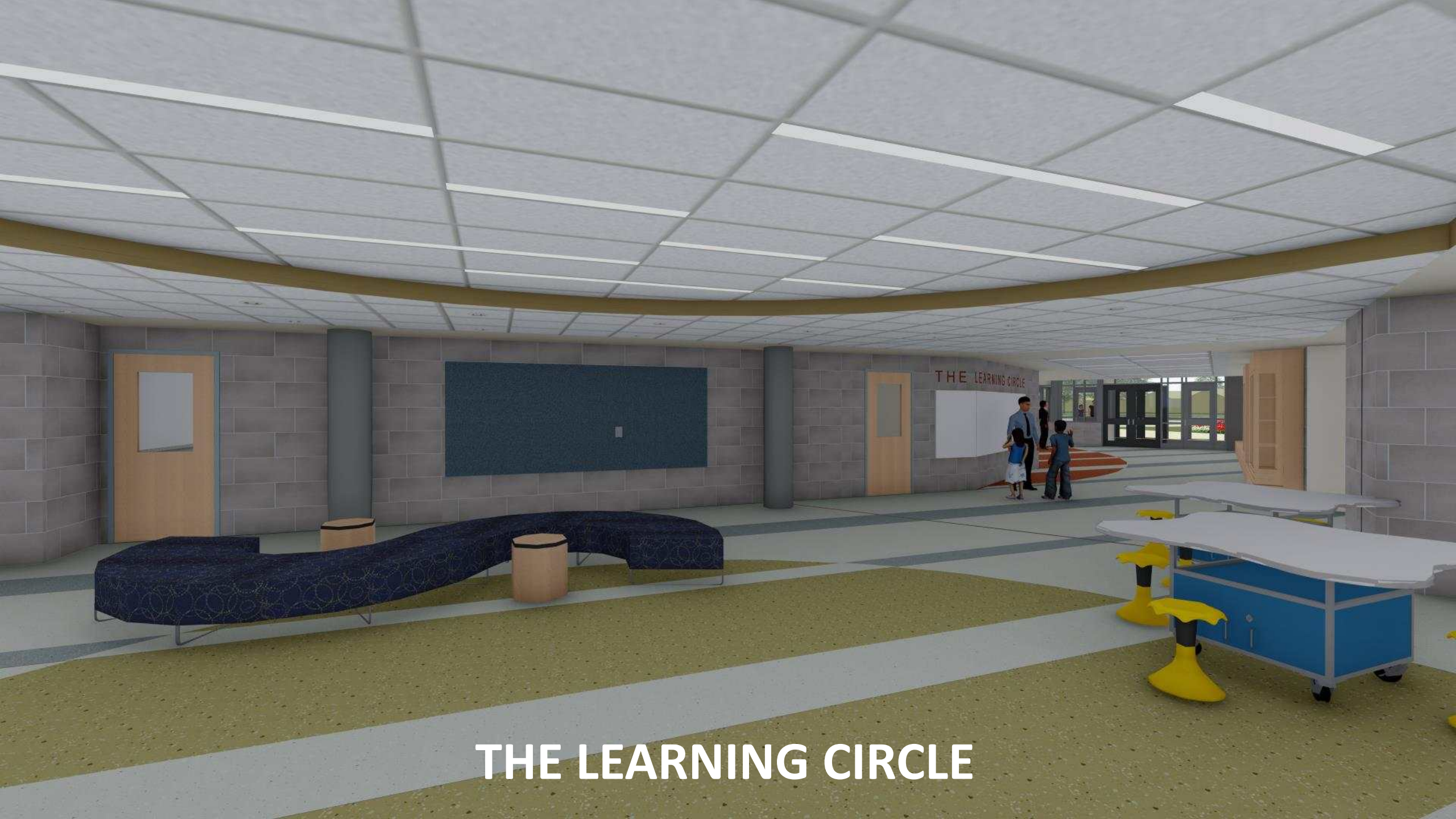

THE LEARNING CIRCLE



CLASSROOM



CLASSROOM



LIBRARY ENTRY AND CIRCULATION DESK



LIBRARY CLASSROOM



GYMNASIUM



CAFETERIA

LYNNEWOOD ELEMENTARY SCHOOL



Actions since last Update

- Project Bidding Open [February]
- Pre-Bid Meeting [March]
- Bids Received [March]
- District Administration Bid Review [March]
- Bids Shared with Facilities Liaisons [March]
- Bidding Due Diligence [March]

LYNNEWOOD ELEMENTARY SCHOOL

LYNNEWOOD BID RESULT SUMMARY

04.25.2019

		Low Bid	Other Bids						
			Boro						
General Trade	ER Stuebner	17,737,000	23,000,000						
Plumbing / Fire Protection	JBM Mech	1,492,000	Stan-Roch	J.Reynolds	Myco Mech	G. Cooper	Dolan		
			1,575,000	1,585,800	1,684,000	1,784,000	2,776,000		
HVAC	JBM Mech	3,672,000	Myco	G.Cooper	Boro	E.J. Meloney	GEM	Five Star	Dolan
			3,677,000	3,759,000	3,789,000	3,960,000	3,949,000	4,195,000	4,238,000
Electrical	Wescott	2,984,000	Boro	Phillips	BSI	McGoldrick			
			3,147,000	3,179,700	3,425,000	3,895,000			

LYNNEWOOD ELEMENTARY SCHOOL



Alternates Recommended

- Terrazzo Flooring in Public Spaces
- Quartz Tile Flooring in Classrooms
- Wood Gymnasium Floor
- Improved Security Glazing
- Sod for the Outdoor Athletic Field
- Interior Display Cases
- Improved Wall Coverings
- Corridor Tack boards
- Operable Partitions
 - Totaling: \$672,500

LYNNEWOOD ELEMENTARY SCHOOL

LYNNEWOOD BID RESULT SUMMARY

04.25.2019

BUDGETS

	Schematic	Design Dev	Construction
General Trade	19,174,000	20,190,000	20,485,000
Plumbing / Fire Protection	1,458,380	1,535,720	1,676,423
HVAC	3,972,625	4,250,809	3,542,070
Electrical	3,854,994	4,180,601	3,505,508
Construction	28,460,000	30,157,130	29,209,000
Soft Costs	4,269,000	4,269,000	4,269,000
Environmental	135,000	135,000	135,000
Escalation	857,000	-	-
Soft / Other	5,261,000	4,404,000	4,404,000
Contingency	2,859,000	2,018,870	2,966,999
Total Projected Costs	36,580,000	36,580,000	36,580,000

BID RESULT / CONTRACT AMOUNT

	Base Bid	Alternates	Total	Delta
ER Stuebner	17,737,000	558,000	18,295,000	2,190,000
JBM Mech	1,492,000	7,500	1,499,500	176,923
JBM Mech	3,672,000	-	3,672,000	(129,930)
Wescott	2,984,000	107,000	3,091,000	414,508
Construction	25,885,000		26,557,500	2,651,500
Soft Costs			4,269,000	
Environmental			-	
Soft / Other			4,269,000	
Contingency			3,300,000	
Total Projected Costs			34,126,500	2,453,500

LYNNEWOOD ELEMENTARY SCHOOL



Projected Timeline

- Apr 26 KCBA Issues intent to award contracts
- May 17 Notice to proceed issued to contractors
- Jun 2019 Construction starts on site
- Sep 2021 School opens

Discussion

